

MAX. DOOR HEIGHT
 ALUMAVIEW OPTIMA = 20' - 0"
 STYLEVIEW WIDE PROFILE = 10' - 0"
 STYLEVIEW CUSTOM PROFILE = 10' - 0"

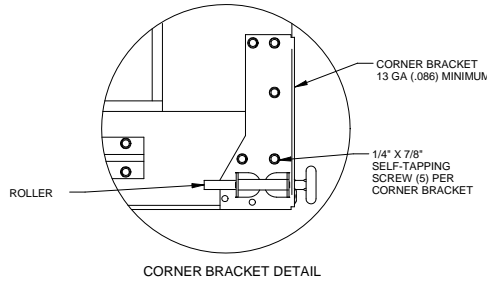
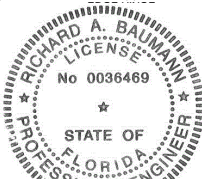
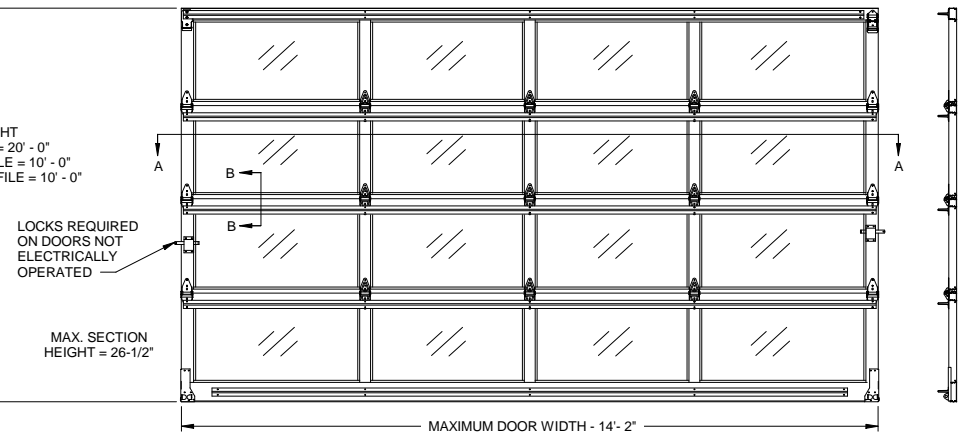

DOORS TESTED PER
 ANSI/DASMA 108
 FOR STATIC AIR PRESSURE

| MAXIMUM DOOR WIDTH | DESIGN LOAD |
|--------------------|-----------------|
| 14' - 2" | + 25.5 - 28.5 |

Richard A. Baumann
 F.P.E #36469
 T.P.E # 85227
 698 Timber Creek Road
 Dixon Illinois 61021

| | | | | | |
|--------------------------------|--|----------------------|---------------|--|--|
| SCALE: NONE | | DRAWN BY: G.WEBEKIND | | TITLE: SPEC, WIND LOAD ALUMAVIEW AND STYLEVIEW | |
| CHECKED BY: GW | | DATE: 07/03/12 | | GARAGE DOORS | |
| REV. A RELEASED FOR PRODUCTION | | ECN NO. 6338.02 | DATE 07/03/12 | NO. P-2410 | |
| DESCRIPTION | | ECN NO. | DATE | SHEET 1 OF 4 | |
| | | ECN NO. 6338.02 | | REV. A | |

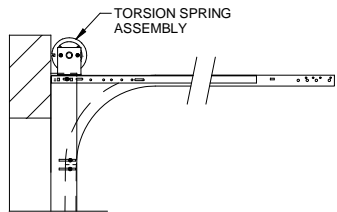

NORMAL HEADROOM TRACK
2" TRACK ANGLE MOUNT SHOWN
2" TRACK BRACKET MOUNT AVAILABLE
3" TRACK ANGLE MOUNT AVAILABLE

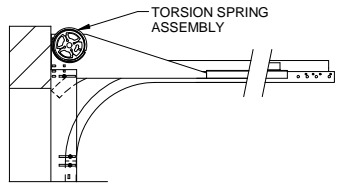

FRONT MOUNT LOW HEADROOM TRACK
2" TRACK ANGLE MOUNT SHOWN
2" TRACK BRACKET MOUNT AVAILABLE
3" TRACK ANGLE MOUNT AVAILABLE

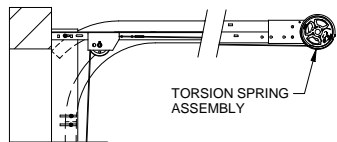

REAR MOUNT LOW HEADROOM TRACK
2" TRACK ANGLE MOUNT SHOWN
2" TRACK BRACKET MOUNT AVAILABLE
3" TRACK ANGLE MOUNT AVAILABLE

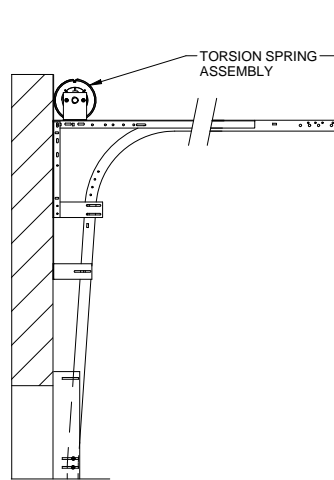

LIFT CLEARANCE TRACK
2" TRACK ANGLE MOUNT SHOWN
2" TRACK BRACKET MOUNT AVAILABLE
3" TRACK ANGLE MOUNT AVAILABLE

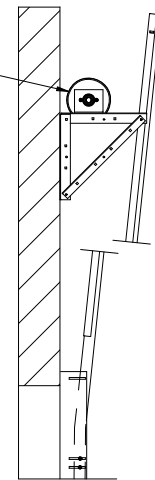

VERTICAL LIFT TRACK
2" TRACK ANGLE MOUNT SHOWN
2" TRACK BRACKET MOUNT AVAILABLE
3" TRACK ANGLE MOUNT AVAILABLE

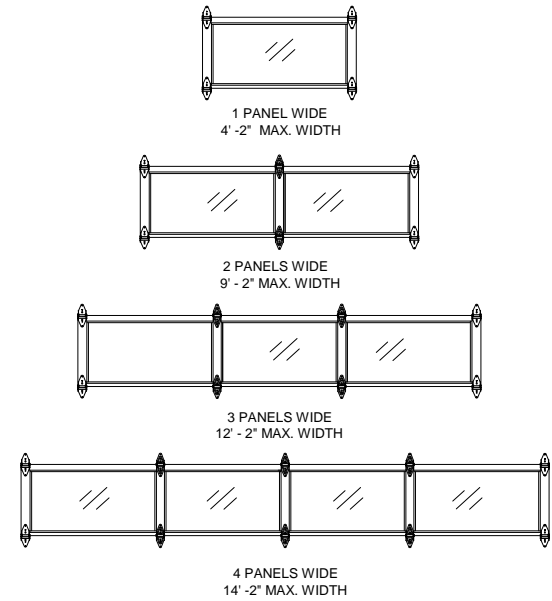

CENTER STILE AND PANEL LAYOUT
INTERIOR VIEW
INTERMEDIATE SECTION SHOWN

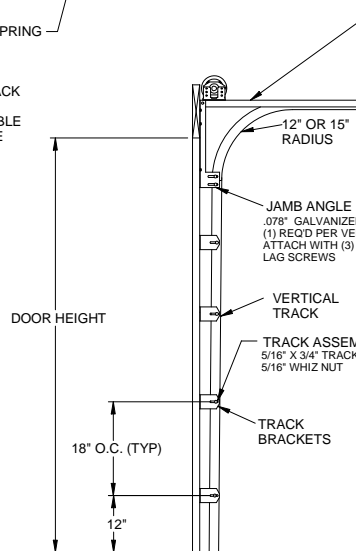
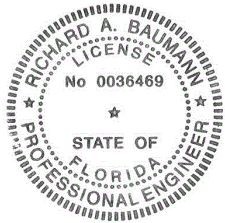

TYPICAL TRACK INSTALLATION
BRACKET MOUNT
WOOD JAMBS

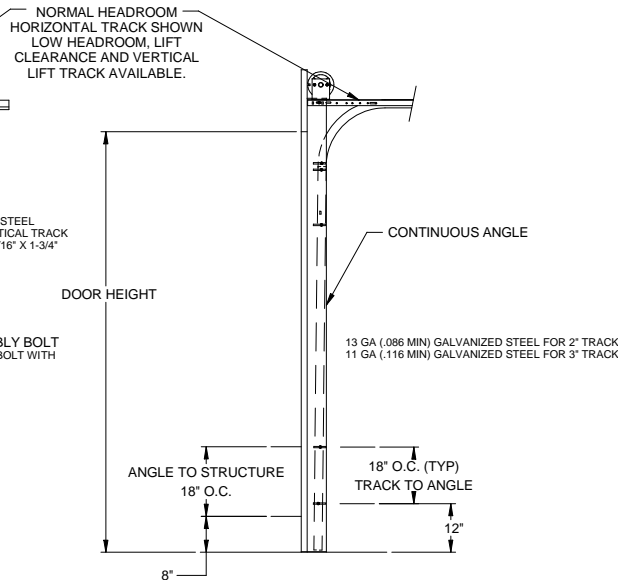

TYPICAL TRACK INSTALLATION
ANGLE MOUNT
WOOD, STEEL OR MASONRY
JAMBS

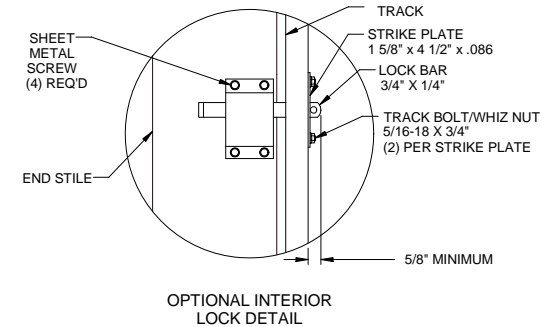

OPTIONAL INTERIOR
LOCK DETAIL

Richard A. Baumann
F.P.E #36469
T.P.E # 85227
698 Timber Creek Road
Dixon Illinois 61021

SCALE: NONE
DRAWN BY: G.WEBEKIND
CHECKED BY: GW
DATE: 07/03/12
ECON. NO.: 6338 02



TITLE: SPEC, WIND LOAD
ALUMAVIEW AND
STYLEVIEW
NO. P-2410 SHEET
2 OF 4 REV
A

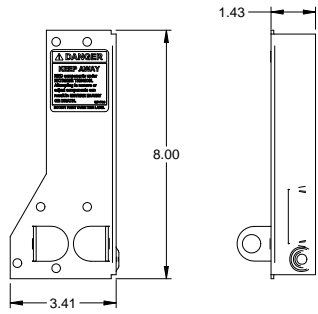

SCALE 1:2
CORNER BRACKET (.086 MIN)
GALV. STEEL

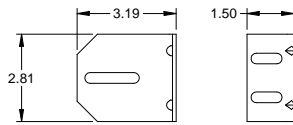

SCALE 1:2
3" TRACK BRACKET
.116 GALV. STEEL

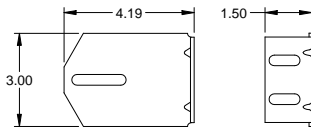

SCALE 1:2
4" TRACK BRACKET
.116 GALV. STEEL

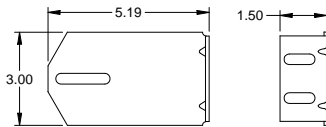

SCALE 1:2
5" TRACK BRACKET
.116 GALV. STEEL

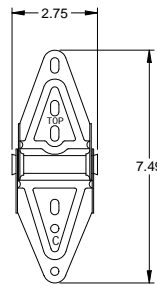

SCALE: 1:2
CENTER HINGE
.045 GALV. STEEL

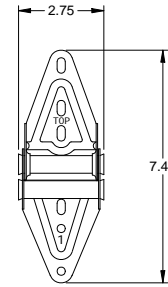

SCALE 1:2
EDGE HINGE
.086 GALV. STEEL

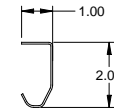

SCALE: 1:2
2" TRACK
.055 MIN. GALV. STEEL

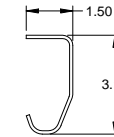

SCALE: 1:2
3" TRACK (OPTIONAL)
.105 GALV. STEEL

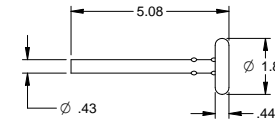

SCALE 1:2
TRACK ROLLER

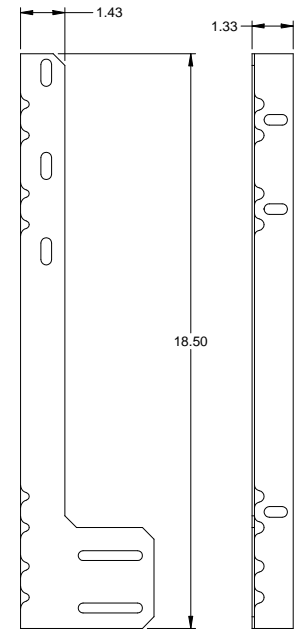

SCALE 1:2
JAMB ANGLE
.078 GALV. STEEL

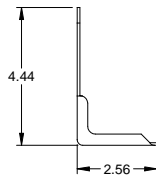

SCALE 1:2
LIGHT COMMERCIAL TOP FIXTURE
(FOR DOORS 5 SECTIONS HIGH OR LESS)
.086 GALV. STEEL

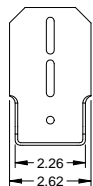

SCALE: 1:2
ROLLER CARRIER
.086 GALV. STEEL
ATTACHED TO LIGHT COMMERCIAL TOP FIXTURE
WITH (2) TRACK BOLTS AND WHIZ NUTS

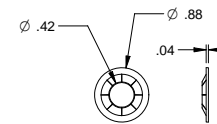
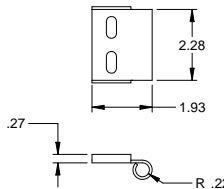

SCALE: 1:1
RETAINING NUT

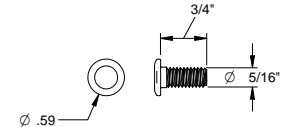

SCALE 1:1
TRACK BOLT

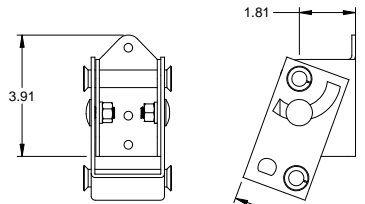

SCALE 1:2
HEAVY COMMERCIAL TOP FIXTURE
.116 GALV. STEEL

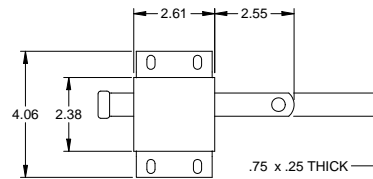

SCALE 1:
SLIDE LOCK (OPTIONAL)
CASE .086 GALV. STEEL

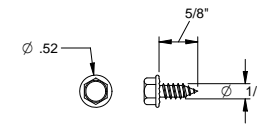

SCALE: 1:1
SHEET METAL SCREW

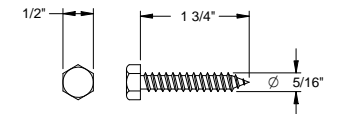

SCALE: 1:1
HEX HEAD LAG SCREW

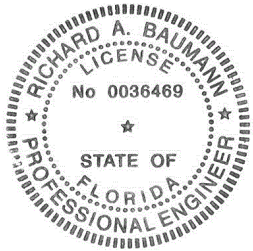

Richard A. Baumann
F.P.E #36469
T.P.E # 85227
698 Timber Creek Road
Dixon Illinois 61021

| | | | | | |
|----------------------|--|--|--------------|-------|--|
| SCALE: NONE | | TITLE: SPEC, WIND LOAD ALUMAVIEW AND STYLEVIEW | | | |
| DRAWN BY: G.WEBEKIND | | NO. P-2410 | SHEET 3 OF 4 | REV A | |
| CHECKED BY: GW | | | | | |
| DATE: 07/03/12 | | | | | |
| ECN NO: 6338 02 | | | | | |

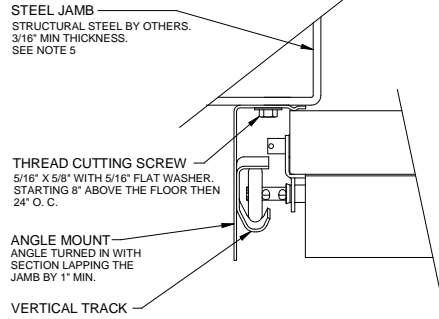

TRACK ASSEMBLY ATTACHMENT TO STEEL JAMB
2\"/>

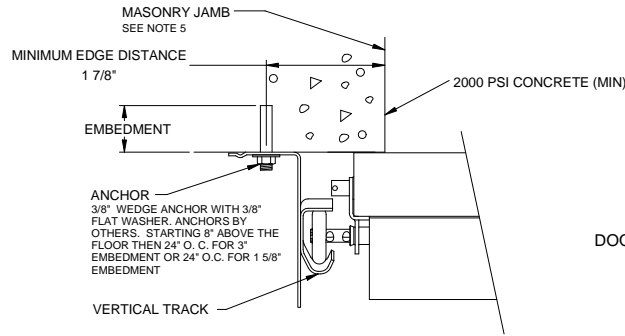

TRACK ASSEMBLY ATTACHMENT TO MASONRY JAMB
2\"/>

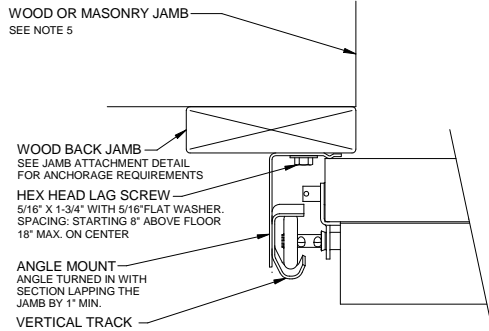
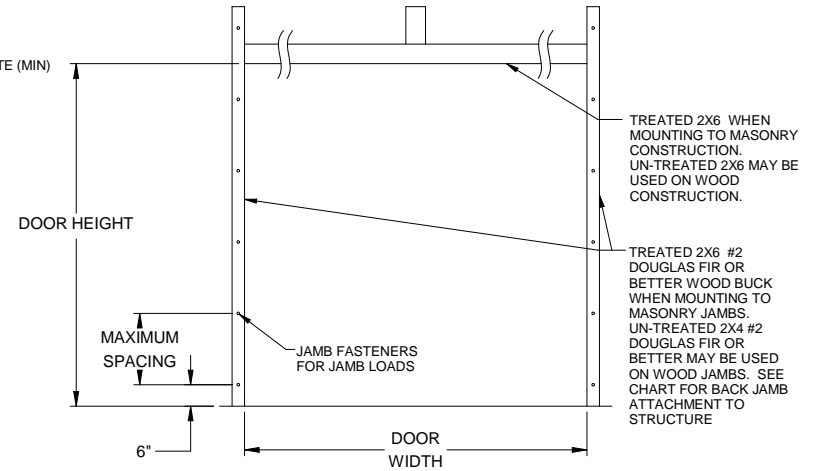

TRACK ASSEMBLY ATTACHMENT TO WOOD BACK JAMB
2\"/>

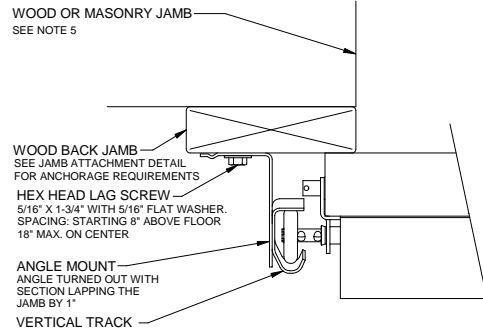

TRACK ASSEMBLY ATTACHMENT TO WOOD BACK JAMB
2\"/>

JAMB ATTACHMENT

| 1/4" ITW BUILDEX TAPCON | | | | |
|----------------------------------|-----------|---------------|------------------------|---------------------------|
| JAMB TYPE | EMBEDMENT | EDGE DISTANCE | ALLOWABLE TENSION LOAD | MAXIMUM ON CENTER SPACING |
| 2000 PSI CONCRETE | 1-3/4" | 2-1/2" | 505 | 24" |
| 3000 PSI CONCRETE | 1-3/4" | 2-1/2" | 550 | 24" |
| 5/16" ITW BUILDEX TAPCON | | | | |
| 3000 PSI CONCRETE | 1-3/4" | 2 3/16" | 563 | 24" |
| POWER ANCHOR - 3/8" WEDGE ANCHOR | | | | |
| 2000 PSI CONCRETE | 1-5/8" | 1-7/8" | 360 | 23-3/4" |
| | 3" | 1-7/8" | 768 | 24" |
| 5/16" LAG SCREW | | | | |
| SPRUCE, PINE, FIR (G = .42) | 1-1/2" | 1-3/4" | 307 | 20-1/4" |
| DOUGLAS FIR (G = .46) | 1-1/2" | 1-3/4" | 352 | 23-1/4" |
| SOUTHERN YELLOW PINE (G = .55) | 1-1/2" | 1-3/4" | 460 | 24" |
| 3/8" LAG SCREW | | | | |
| SPRUCE, PINE, FIR (G = .42) | 1-1/2" | 1-3/4" | 352 | 23-1/4" |
| DOUGLAS FIR (G = .46) | 1-1/2" | 1-3/4" | 403 | 24" |
| SOUTHERN YELLOW PINE (G = .55) | 1-1/2" | 1-3/4" | 528 | 24" |
| 5/16 X 5/8 THREAD CUTTING SCREW | | | | |
| STEEL A 36 | 3/16" | 1/2" | 1048 | 24" |

JAMB ATTACHMENT NOTES

- 1/4" DIAMETER ANCHORS REQUIRE 5/8" MIN. O.D. STEEL WASHER.
- 5/16" AND 3/8" DIAMETER FASTENERS REQUIRE 7/8" MIN O.D. STEEL WASHER.
- MAXIMUM POSITIVE LOAD PER JAMB = (14'-2" X 25.5 PSF) / 2 = 181 LBS PER FOOT.
- MAXIMUM NEGATIVE LOAD PER JAMB = (14'-2" X 28.5 PSF) / 2 = 202 LBS PER FOOT.
- DESIGN OF THE SUPPORTING STRUCTURE SHALL BE THE SOLE RESPONSIBILITY OF THE BUILDING DESIGNER AND SHALL BE DESIGNED FOR THE JAMB LOADS LISTED IN NOTES 3 AND 4.
- ALTERNATE JAMB ATTACHMENTS MAY BE USED IF APPROVED BY A REGISTERED PROFESSIONAL ENGINEER.

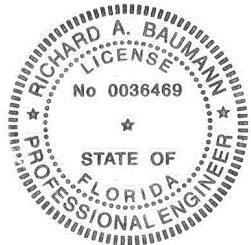

Richard A. Baumann
F.P.E #36469
T.P.E # 85227
698 Timber Creek Road
Dixon Illinois 61021

| | | | |
|----------------------|--|--|--------------|
| SCALE: NONE | | TITLE: SPEC, WIND LOAD ALUMAVIEW AND STYLEVIEW | |
| DRAWN BY: G.WEBEKIND | | NO. P-2410 | |
| CHECKED BY: GW | | | SHEET 4 OF 4 |
| DATE: 07/03/12 | | | REV A |
| ECON. NO. 6338 02 | | | |